

油管裁切器使用方式

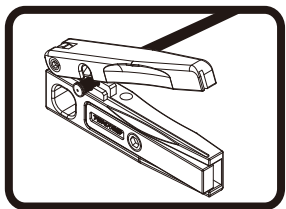

將油管平放於裁切槽，壓下板手並裁切所需油管長度，油管切口須平整且無毛邊。

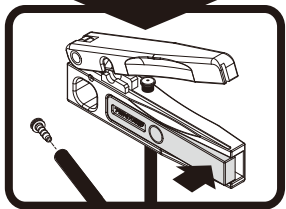

將含O型環之油管襯套置入油管，油管穿過裁切器底部圓孔，按住壓板夾住油管。

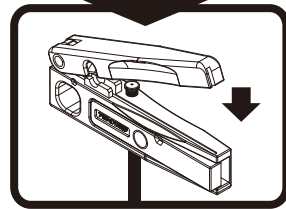

將板手壓下，使油管襯套壓入油管，油管襯套需與油管裁切面緊貼避免漏油。

⚠
注意

- 1) 請勿將手指放在裁切器口,避免受傷。
- 2) 請置於孩童無法拿取地方。
- 3) 油管裁切面需平整,若有歪斜或毛邊現象,請立即更換刀片,使用一般美工刀片替換即可。

HOSE CUTTER

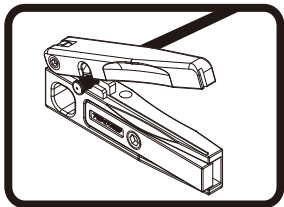

Put tubing in the cutting groove and pushed down the cutter to cut the required length. Tubing must to be flat and free of burrs.

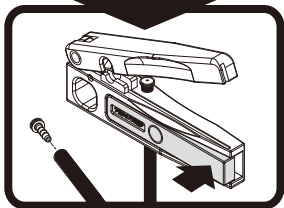

Put compression insert with O-ring into the tubing. Put tubing through the hole at the bottom of base and press the clip to hold the tube.

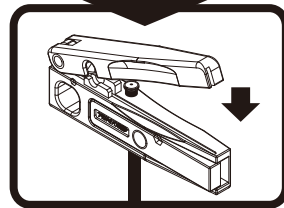

Push down the cutter to press insert into tubing properly.

CAUTION

- 1) To avoid injuries, do not put your finger in the cutter.
- 2) Always keep out of reach of children.
- 3) Tube cutting surface to be smooth, if burr at edge please replace with new blade