

Magnet Set for Speed Sensor Spec

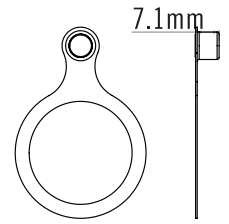
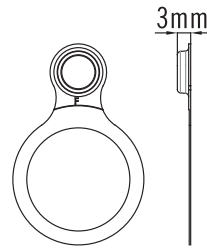
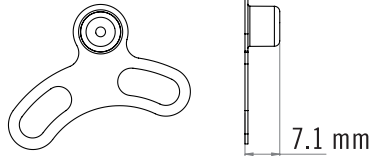
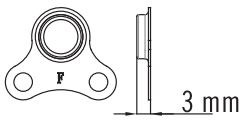

SP-SS10

The magnet for six bolts rotor.
Magnet toward outward.

TR02

The magnet for six bolts rotor
Magnet toward inward.

SP-SS20

The magnet for center lock rotor
Magnet toward outward.

SP-SS30

The magnet for center lock rotor
Magnet toward inward.

The cross section area between $\varnothing 45$ to $\varnothing 80$ is the interference area.

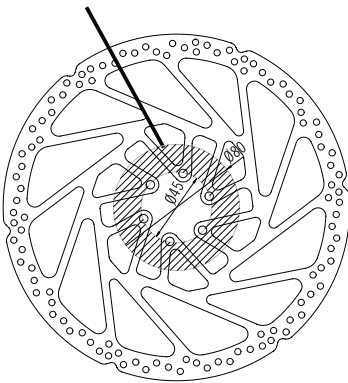

For SP-SS10 / SP-SS20
Clearance between the interference area and the bike frame must be greater than or equal to 5mm

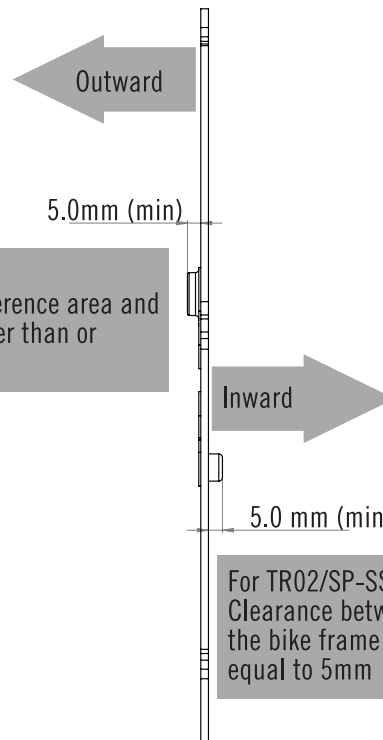

For TR02/SP-SS30
Clearance between the interference area and the bike frame must be greater than or equal to 5mm

ITEM	SIX BOLTS ROTOR MODELS	Center Lock Rotor
SP-SS10	TEKTRO/TRP Six Bolts Rotor	NO COMPATIBLE
SP-SS20	NO COMPATIBLE	TRP all center lock rotor
TR02	TRP : RS02M* / RS01E* TEKTRO : TR*16 / TR*17 / TR24* / TR52* / TR53* / TR54*	NO COMPATIBLE
SP-SS30	Use CL rotor adapter sets(CL hub to six bolts rotor) :TRP SP-CL81/CL86 TRP : RS02M* / RS01E* TEKTRO : TR16* / TR17* / TR24* / TR52* / TR53* / TR54*	TRP : TR140-25 / TR160-25 / TR180-25 / RS160C01E / RS180C01E TEKTRO : TR35* / TR35A* / TR45* / TR54*