

INSTALLATION INSTRUCTIONS FOR DROP BAR BRAKE LEVER

The drop bar brake levers you purchased have been designed to meet the highest standards of excellence in both function and craftsmanship.

The installation setup of your drop bar brake levers should be performed by a qualified technician. Visit your local service center or www.tekpro.com for more information.

Tools You'll Need:

5mm Allen Key – for mounting bolts

Compatibility:

All drop bar Brake lever models are compatible with standard road drop handlebars

A - MOUNT THE LEVER TO THE HANDLEBAR

1. Depress the brake blade to expose the 5mm Allen bolt inside the lever, loosen the handlebar clamp enough that it will slip over the end of the bar.
2. Slip the clamp onto the end of the handlebar and slide into position. A good starting point is with the bottom of the blade level with the bottom of the drop portion of the handlebar. The levers are R and L side specific.
3. Once positioned, tighten the 5mm Allen bolt to 6-8 Nm.

5mm Allen key
Final tightening torque: 6-8 Nm

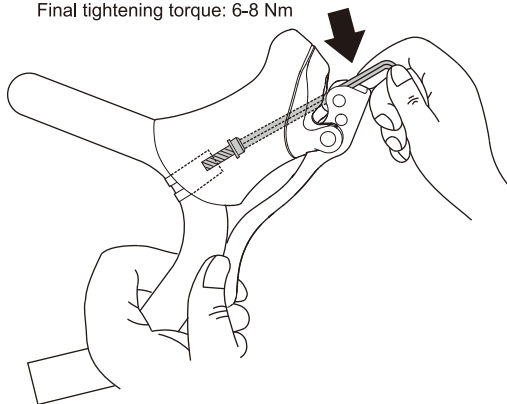

B - ROUTE THE BRAKE CABLE AND HOUSING

1. Once the lever is securely fastened to the bar, insert the brake cable through the cable hook and pull through the back side of the lever.
2. Measure and cut the appropriate length of cable housing, making sure that the end of the cable housing is firmly seated in the brake lever.

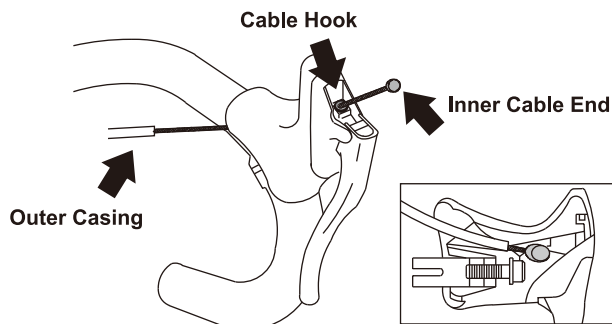

3. Route the cable through the housing and into position and secure the housing to the bar.

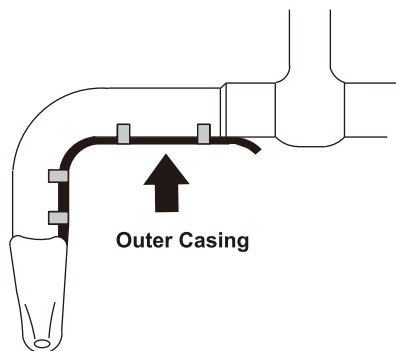

4. Finally, route the cable through the brake and adjust to the brake manufacturers specifications, and secure the brake.

C - INTEGRATED CABLE RELEASE

1. To release cable tension, depress the cable release button located on the side of the lever hood.
2. To return to normal cable tension, simply pull the drop bar brake lever blade in until the button returns to it's normal position.

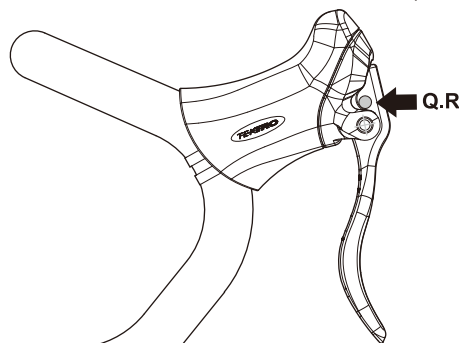

D - SAFETY CHECK

1. Always test your brake set up and operation at low speeds prior to regular use.
2. TEKTRO brakes is not liable for accidents resulting from faulty set up and lack of proper safety review.

Warning

1. It is require practice at slow speeds before normal use.
2. If you are unsure about any part the installation and set up of these levers, consult a qualified mechanic or your local bike dealer.
3. Tektro is not liable for damage or injury as a result of improper installation or use.